

Extending the tripod legs

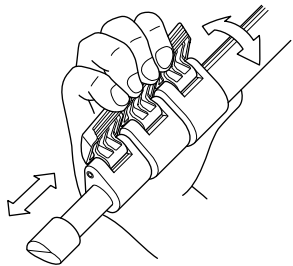

Flip up the leg lock lever to extend or shorten any of the individual leg sections to the desired length and press the leg lock lever flush against the leg to lock.



It is easier to extend the tripod legs if you turn the leg-tips to the foot, while leaving legs close.

Operating the center column

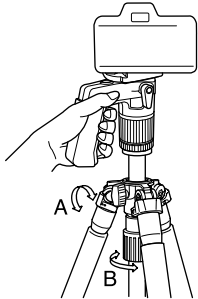

A - Screw-type
Center column stopper is used to lock or unlock center column.
B - Twist-type
Center column locking nut is used to adjust a tension of the movement.
The both of A and B must be locked for fixing center column.

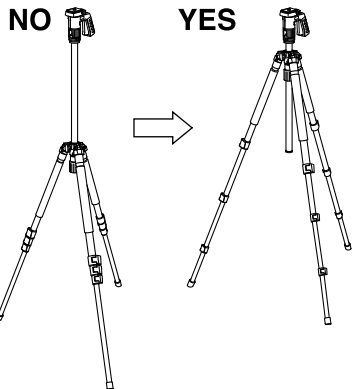

To avoid unnecessary camera vibrations, try to keep the center column height to a minimum.
Also use the larger legs first when extending the legs.

How to get low position shots

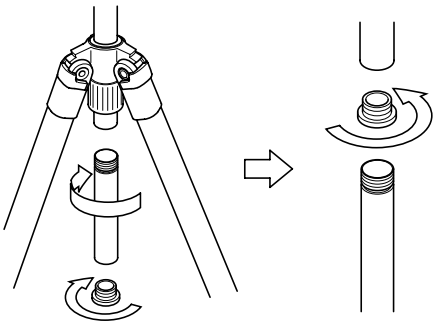
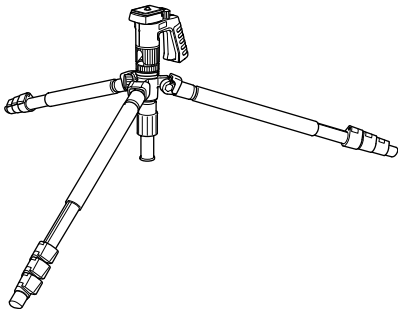

Remove the center column base stopper and then, remove the lower part of center column.
Put the center column base stopper on the upper part of center column.

Care of the Tripod

- DO NOT apply any grease or oil to this product.
- Clean with a mild detergent and a soft cloth only.
- DO NOT use close to flame. Avoid extreme heat.

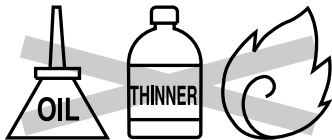

Slik Corporation reserves the right to make changes in design and/or mprovements on the products without any obligation and ad vanced notice.

SLIK®

PRO 330AF Tripod

Operating Instructions

Thank you very much for choosing the SLIK PRO 330AF Tripod.
The SLIK Corporation has designed your tripod to be a sturdy, rugged, dependable product that will provide you with many years of satisfacto-ry use.
Please take a few moments to read these operating instructions carefully before use so that you can take full advantage of your Tripod's many fine features. Retain this operating instruction sheet in case you might want to refer back to it.

⚠ Caution

This caution icon refers to information pertaining to important safety procedures in preventing injuries, or damages which may occur as a result of mishandling this product.

🚫 Prohibition

This prohibited icon refers to information pertaining to prohibited con-tents. Please refer to instructions closely to avoid accidents.

J828-1

Components

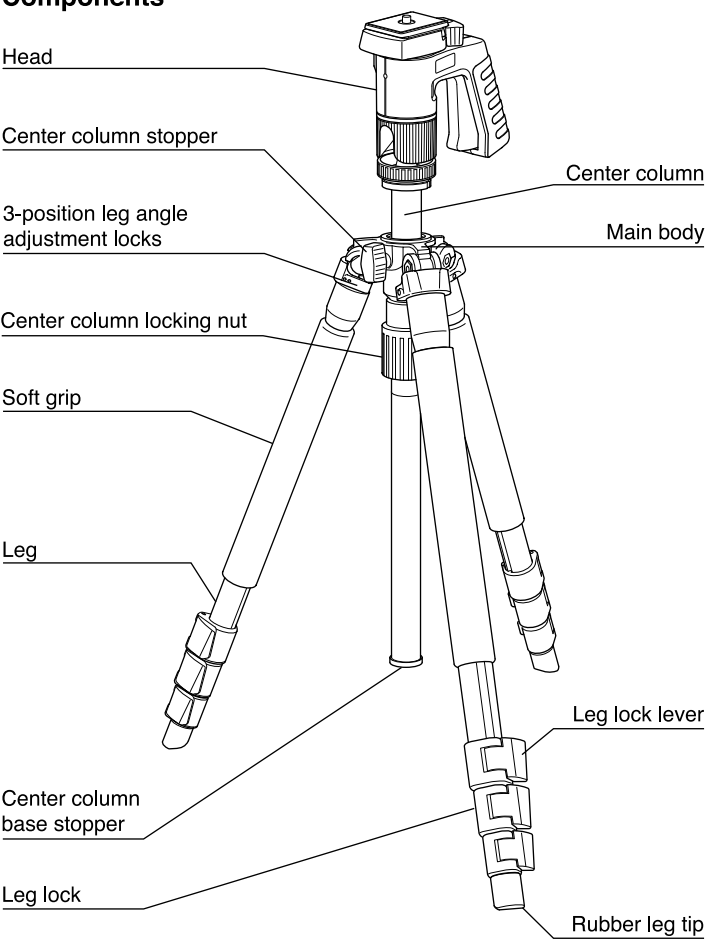

⚠ Caution

Soft grip is consumable and cannot be used permanently.
Please replace it whenever ragged.

Head

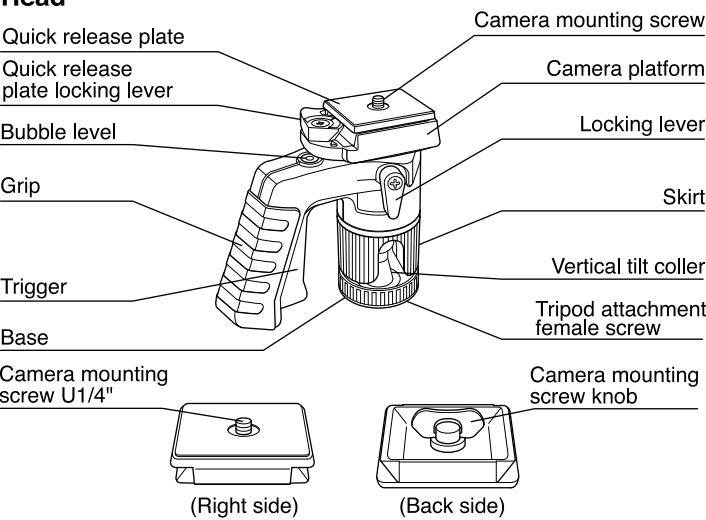

Equipment that can be loaded on this tripod

🚫 Prohibition

This product has been designed to handle equipment weighing under 1.5kgs (3 lbs 5 oz).
Do not overload.
Some equipments weighing over 1.5kgs (3 lbs 5 oz), such as long lenses, may not balance well due to its weight distribution.
In such case, please use a larger tripod.

Carrying the tripod

🚫 Prohibition

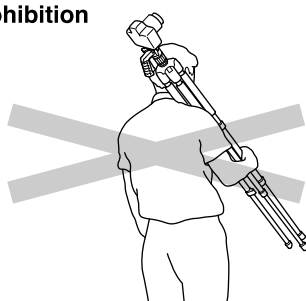

Carrying a tripod with a camera left on can result in unexpected accidents.
We, therefore, recommend you to remove your camera while carrying the tripod.

Setting up

⚠ Caution

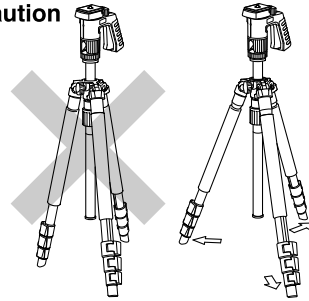

To prevent accidental equipment fall or tripod tipping over, making sure all levers, knobs and handles on the tripod are securely tightened.
And all of the three legs are opened all the way.

Pan head mounting post

🚫 Prohibition

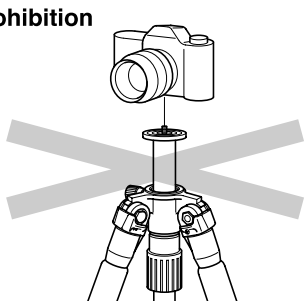

Do not attach a camera directly to the pan head attachment screw.
This may damage both your camera and tripod.

Attaching the camera to the quick release plate

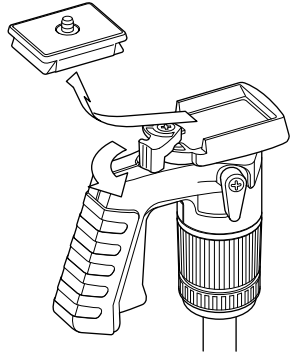

Remove the quick release plate turning the quick release plate locking lever.

⊘ Prohibition

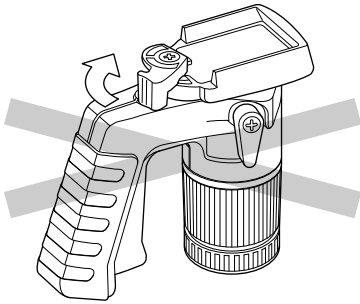

In this case, please do not put the quick release plate locking lever back by force as it has been stood by the stopper.

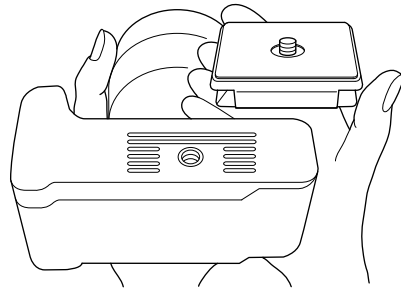

Insert the camera mounting screw of the plate in the place of the tripod attachment screw of your camera.

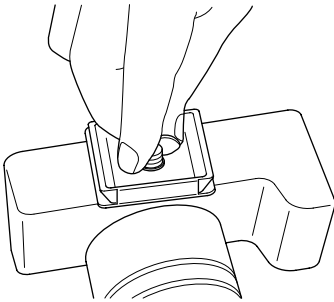

Turn the camera mounting screw knob and fix firmly.

Using the head (Continued)

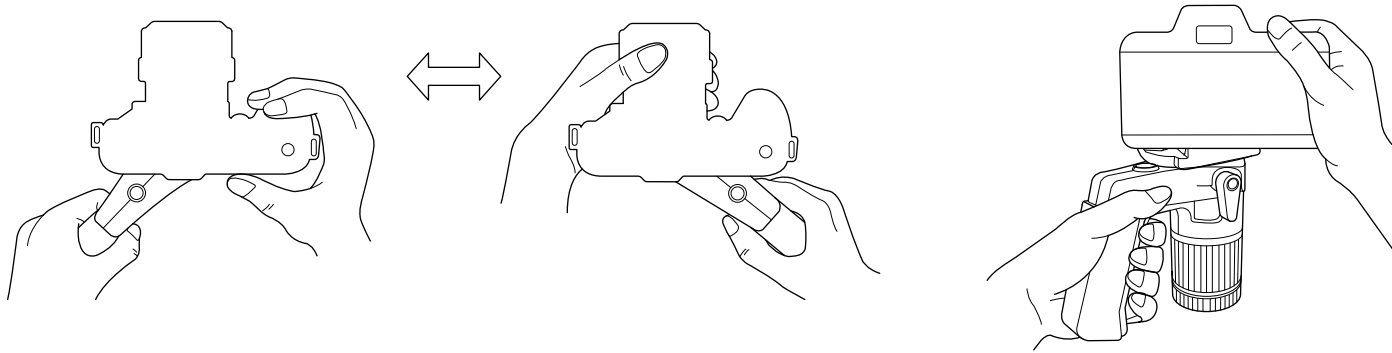

The position of the grip can be freely chosen as the camera platform rotates. Please fix the camera platform with the locking lever when you decide your required position.

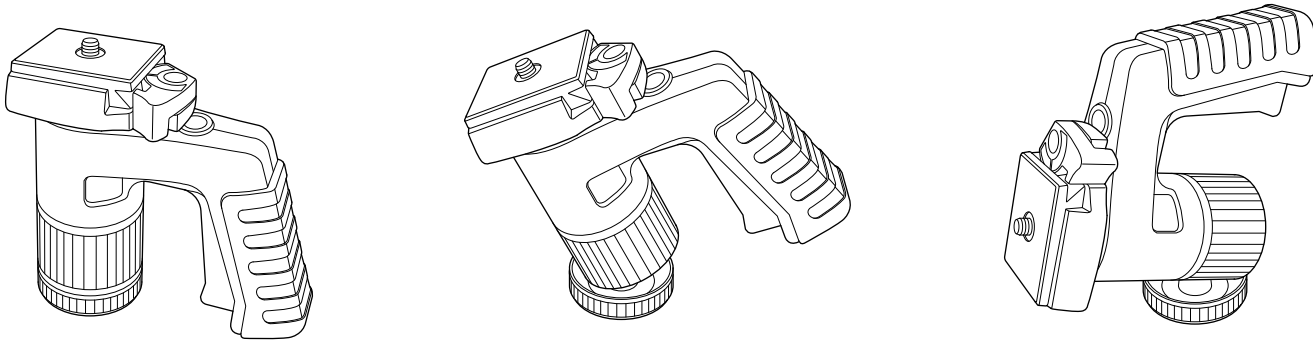

The ball head can be inclined up to 90 degrees to the direction of the skirt of U-ditch. You can get any angles if you use the rotation of the skirt and the camera platform.

Three position adjustable legs

⚠ Caution

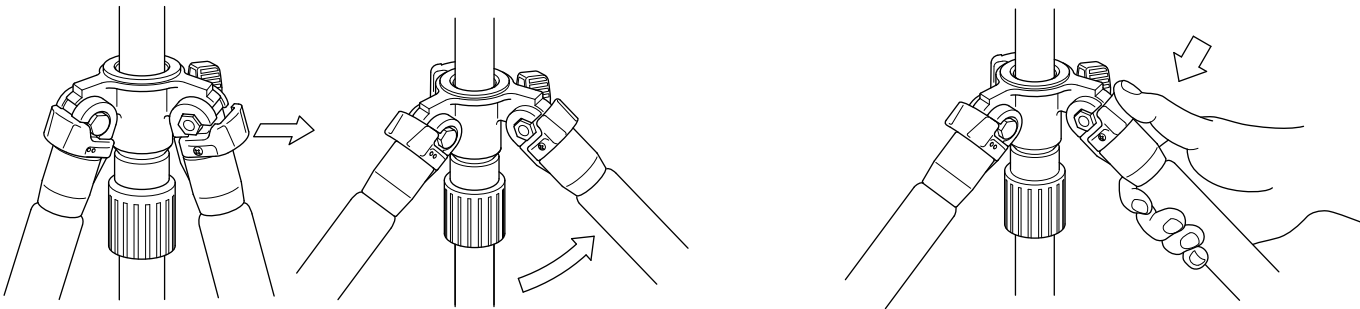

To change the angle of each leg, close the leg slightly, and then pull the leg angle adjustment lock out. There is a choice of two other angle positions.

After choosing the desired leg angle, securely push in the adjustment lock.

Using the head

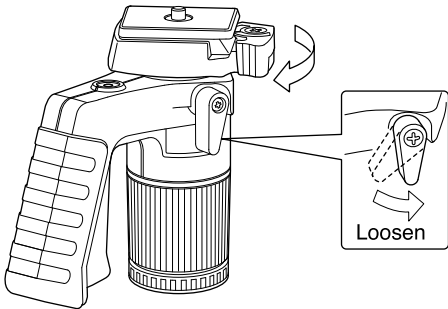

The camera platform rotates when the camera platform locking lever is loosened in the direction of the arrow.

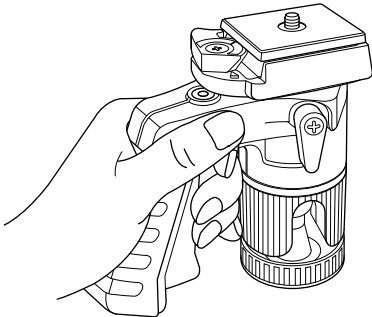

It moves when the grip is grasped, and pull the trigger. The skirt also rotates. If the trigger is released, it locks.

Inverting the center column

⚠ Caution

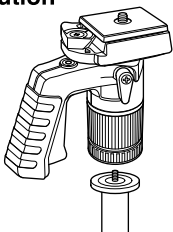

Remove the pan head when inverting or replacing the center column.

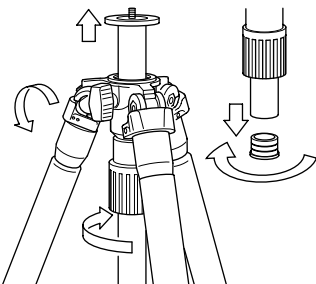

Remove the center column base stopper from the bottom of the center column. Loosen the center column stopper and the locking collar, and then pull out the center column.

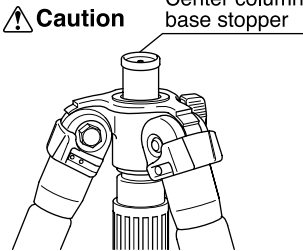

Insert the new replacement center column through the top, and tighten the locking collar. Always be sure to return the center column base stopper back on the bottom of the center column, as this prevents the center column from being accidentally pulled out.

⊘ Prohibition

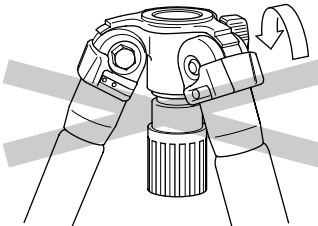

Please do not turn the center column stopper without a center column &/or an optional short center column. The internal parts may be damaged.